

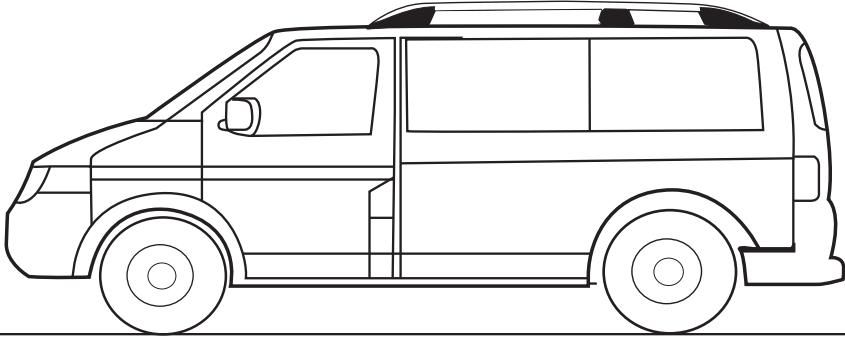

ONTEC
AUTO ACCESSORIES.CO



VW T5 Transporter
VW T5 Caravelle **2003-2015**
VW T5 Multivan
VW T6 Transporter
VW T6 Caravelle **2015>**
VW T6 Multivan

| | | |
|-------------|----------------------------------|-------------------------|
| (TR) | Montaj Talimatı : | PORT BAGAJ |
| (GB) | Fitting Instructions : | ROOF RACK |
| (D) | Montageanleitung : | DACHRELING |
| (F) | Instructions de Montage : | RIDELLES DE TOIT |

(TR)

*Port bagaj taşıma kapasitesi 75 kg. olup; yükleme yapmadan önce aracın tavan taşıma kapasitesinin dikkate alınması gerekir.

(GB)

*Roof Rack carrying capacity is maximum 75 kg. Please check your vehicle roof maximum carrying capacity from your car manufacturer before load roof rack.

(G)

*Maximale Traglast unsere Dachrelinge betragen 75kg. Die freigegebenen Dachlasten der Fahrzeughersteller dürfen nicht überschritten werden. Bitte zur Kenntnisnahme!

(F)

*La capacité de chargement maximale est de 75 Kg. Nous vous prions de vérifier la capacité de chargement du toit de votre véhicule avant de charger les barres de toit.



30 Min.

①



M7522930

PARÇA LİSTESİ

Part List / Teileliste / Lista de accesorios

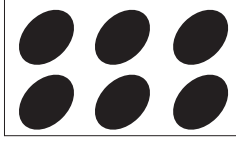

- (TR) PLASTİK TAPA = 6 PARÇA
- (GB) PLASTIC PLUG = 6 PIECES
- (D) GUMMISTOPFEN = 6 STÜCK
- (F) BOUCHON PLASTIQUE = 6 PIÈCES

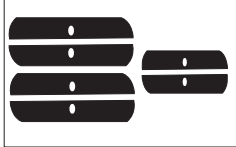

- (TR) BRAKET = 6 PARÇA
- (GB) BRACKET = 6 PIECES
- (D) HALTERUNG = 6 STÜCK
- (F) PATTE DE FIXATION = 6 PIÈCES

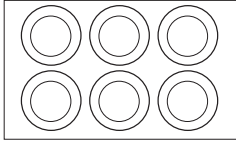

- (TR) PUL = 6 PARÇA
- (GB) RING WASHER = 6 PIECES
- (D) UNTERLEGSCHLEIBE = 6 STÜCK
- (F) RONDELLE AUTOBLOQUANTE = 6 PIÈCES

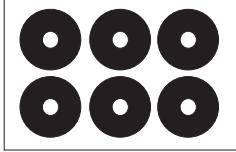

- (TR) SIZDIRMAZLIK ELEMANI = 6 PARÇA
- (GB) IMPERMEABLE RUBBER = 6 PIECES
- (D) KUNSTSTOFF-DICHTUNG = 6 STÜCK
- (F) JOINT EN PLASTIQUE = 6 PIÈCES

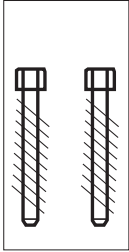
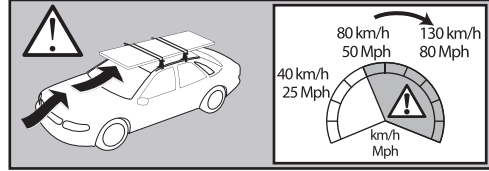
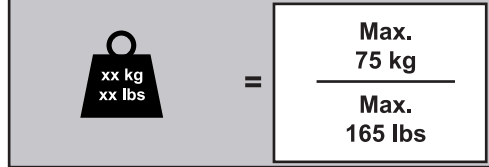

m-6 x 60 (FRONT-2 PIECES)

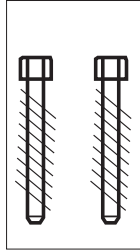

m-6 x 80 (MIDDLE-2 PIECES)

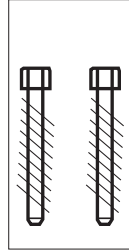

m-6 x 60 (REAR-2 PIECES)

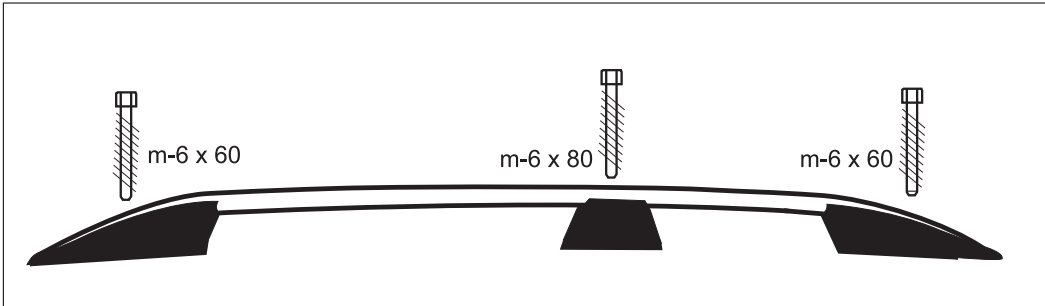

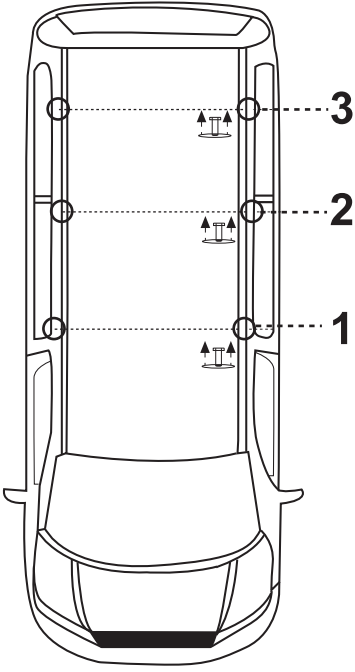

1) 1-2 ve 3 Numaralı civataları araç üzerinden çıkartınız.

1) Please pull off the numbered screws (1-2-3) from the vehicle.

1) Entnehmen Sie die Schrauben die auf den Dach vormontiert worden sind.

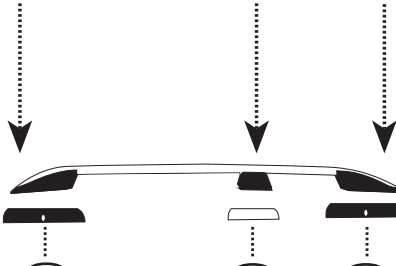

TR BRAKET = 6 PARÇA
GB BRACKET = 6 PIECES
D HALTERUNG = 6 STUCK

TR SIZDIRMAZLIK ELEMANI
GB IMPERMEABLE RUBBER
D KUNSTSTOFF-DICHTUNG

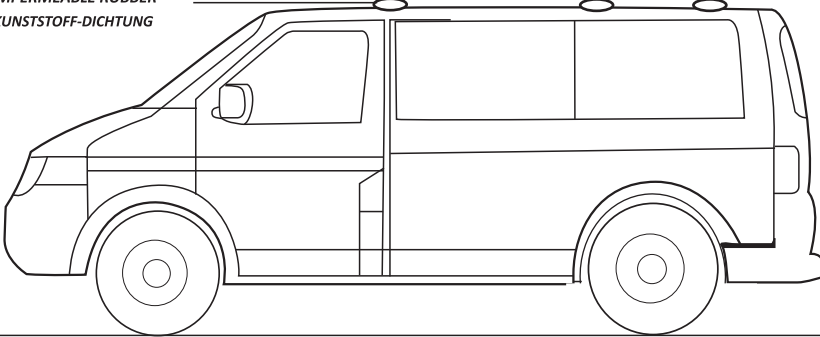

2) - Sızdırmazlık elemanın yapıştırılması - Besleme parçalarının yerlerine yerleştirilmesi

2) - After unscrewing and pulling of the original bolts of vehicle, to prevent leaking issues please peel off rubber sealing foams surface and apply them upon each hole.
- When foam is applied, put the needed brackets on to each hole.

2) Nach Abnahme der Original Schraube vom Dach, legen Sie die Gummidichtungen an die offene Schrauböffnung und platzieren Sie zum Schluss die Kunststoff Dichtungen.

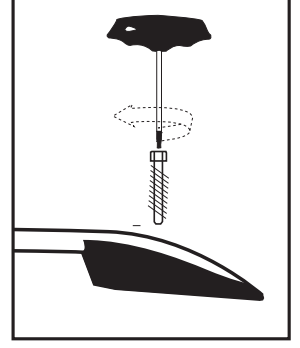
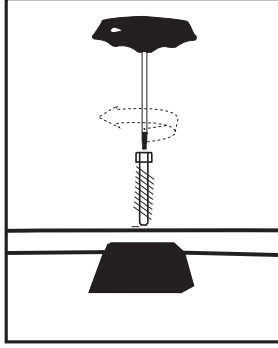
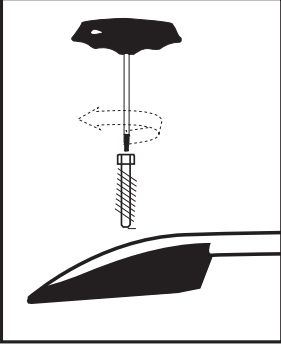

3) Port Bagajı araç üzerine montaj yerlerinden sabitleyip sıkınız.

3) Align the holes in each rails with the hole on the roof then install roof rails by tighten the screws

3) Fixieren Sie den Dachträger an den Montierstellen und befestigen Sie diesen.

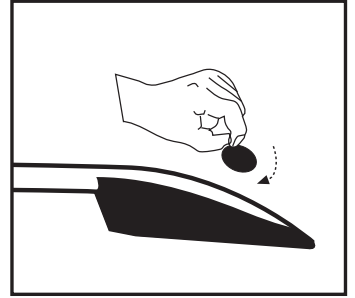
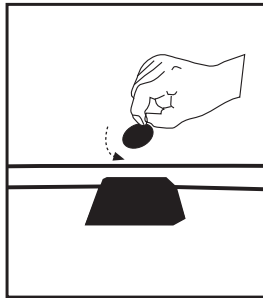
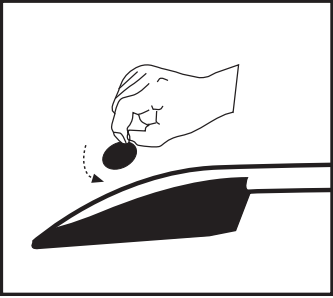

4) Port Bagajın tapalarını yerlerine yerleştirerek montajı tamamlayınız.

4) Tap the plugs on roof rails.

4) Stecken Sie die Stopper in Ihre Plätze und schließen Sie diese.